

GENERAL MACHINING TOLERANCE - GRADE MEDIUM (UNI EN ISO 22768)													
TOLLERANZA GENERALE DI LAVORAZIONE - GRADO MEDIO (UNI EN ISO 22768)													
Size	above	Gruppo di dimensioni fino a	-										4000
	up to		6	30	120	400	1000	2000	4000				
Tolerance	Scostamenti		±0.1	±0.2	±0.3	±0.5	±0.8	±1.2	±2	±3			

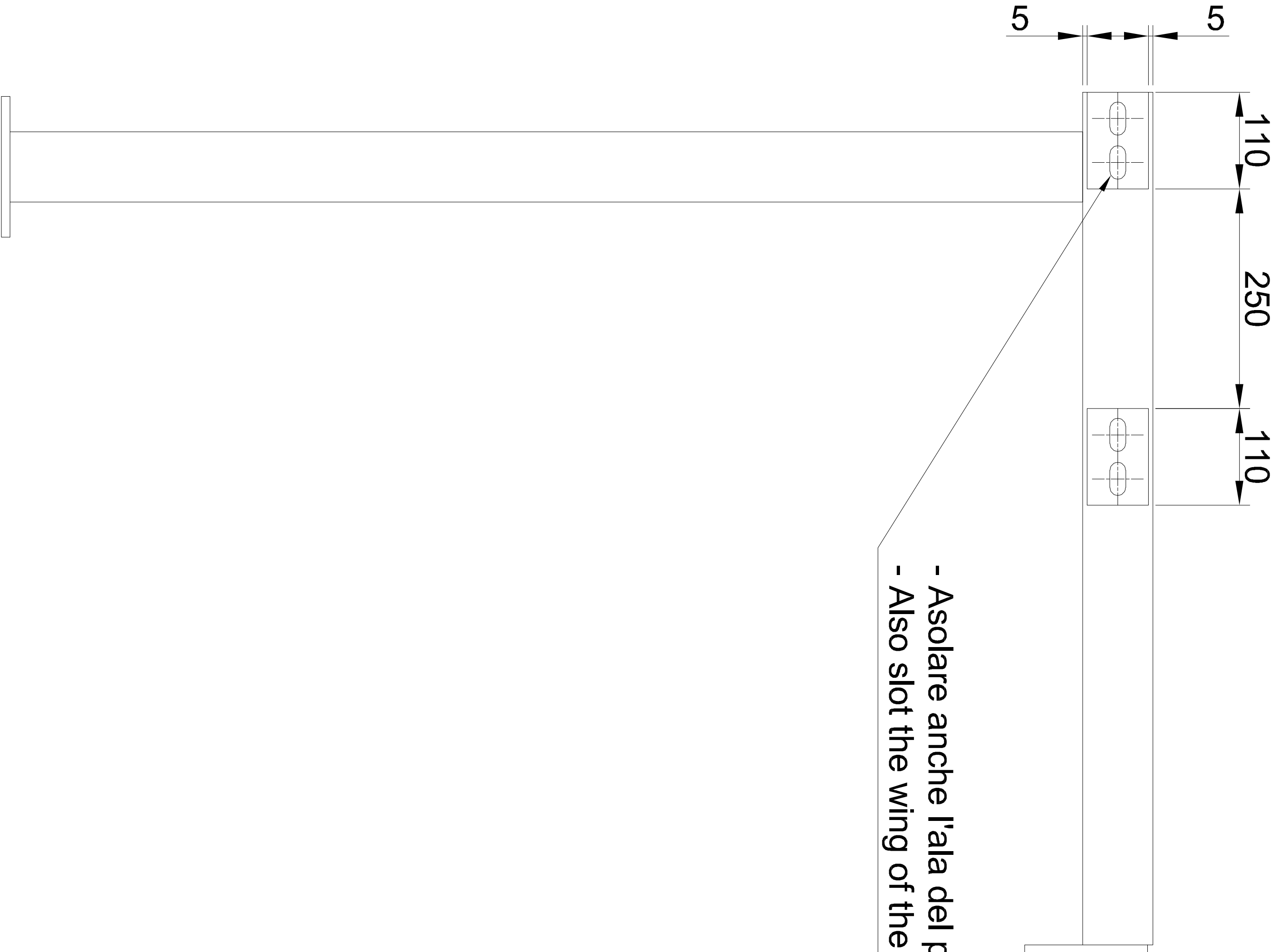

- Asolare anche l'ala del profilo
- Also slot the wing of the profile

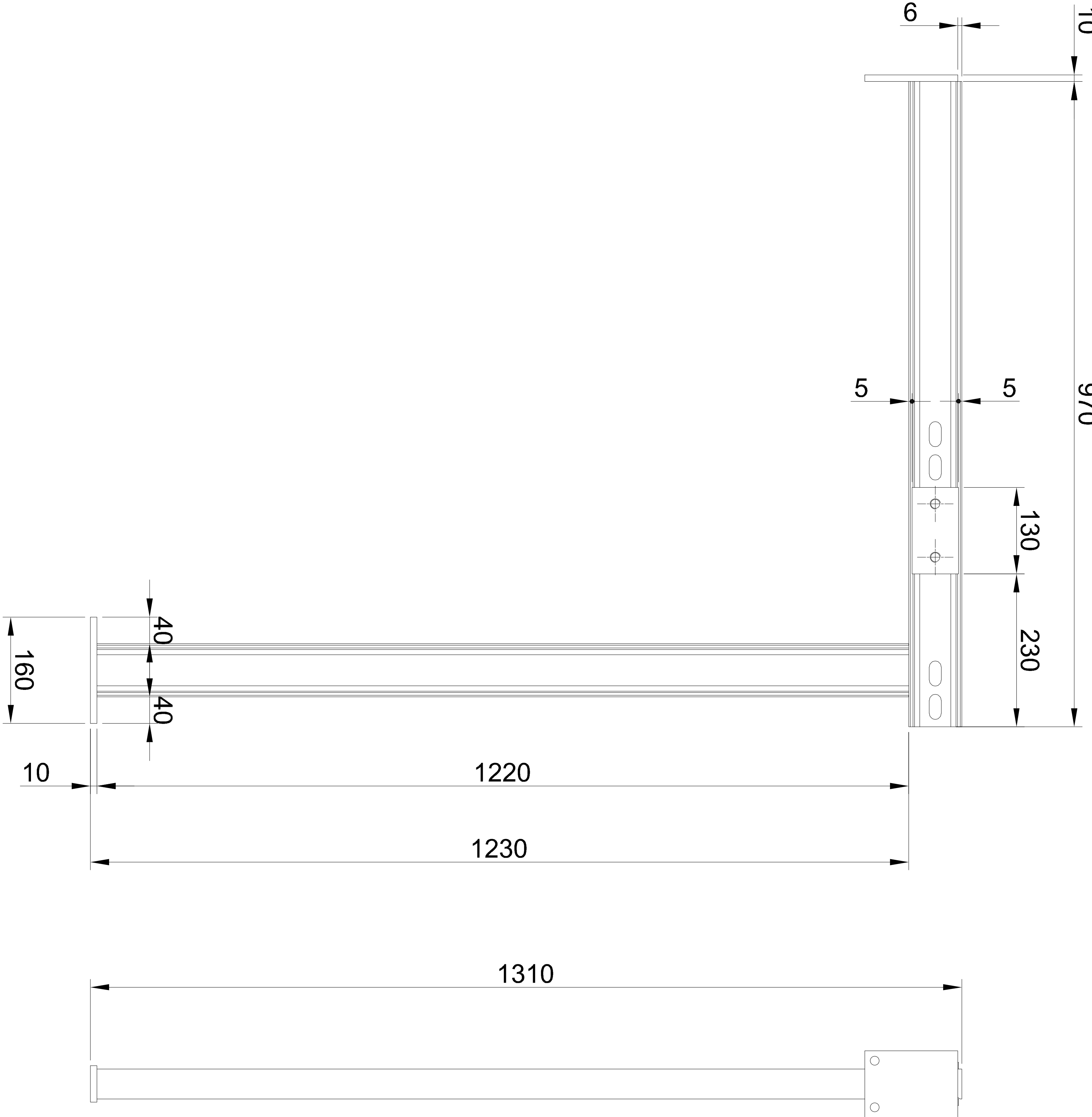
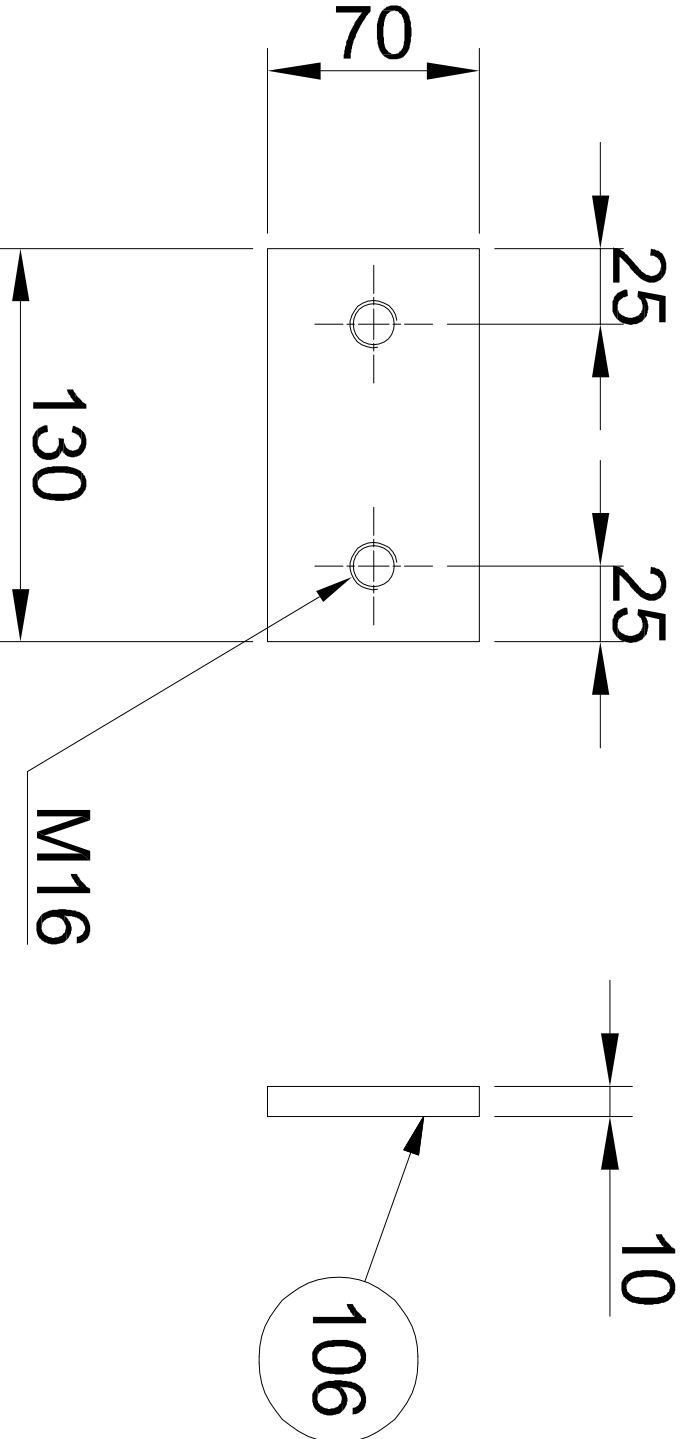
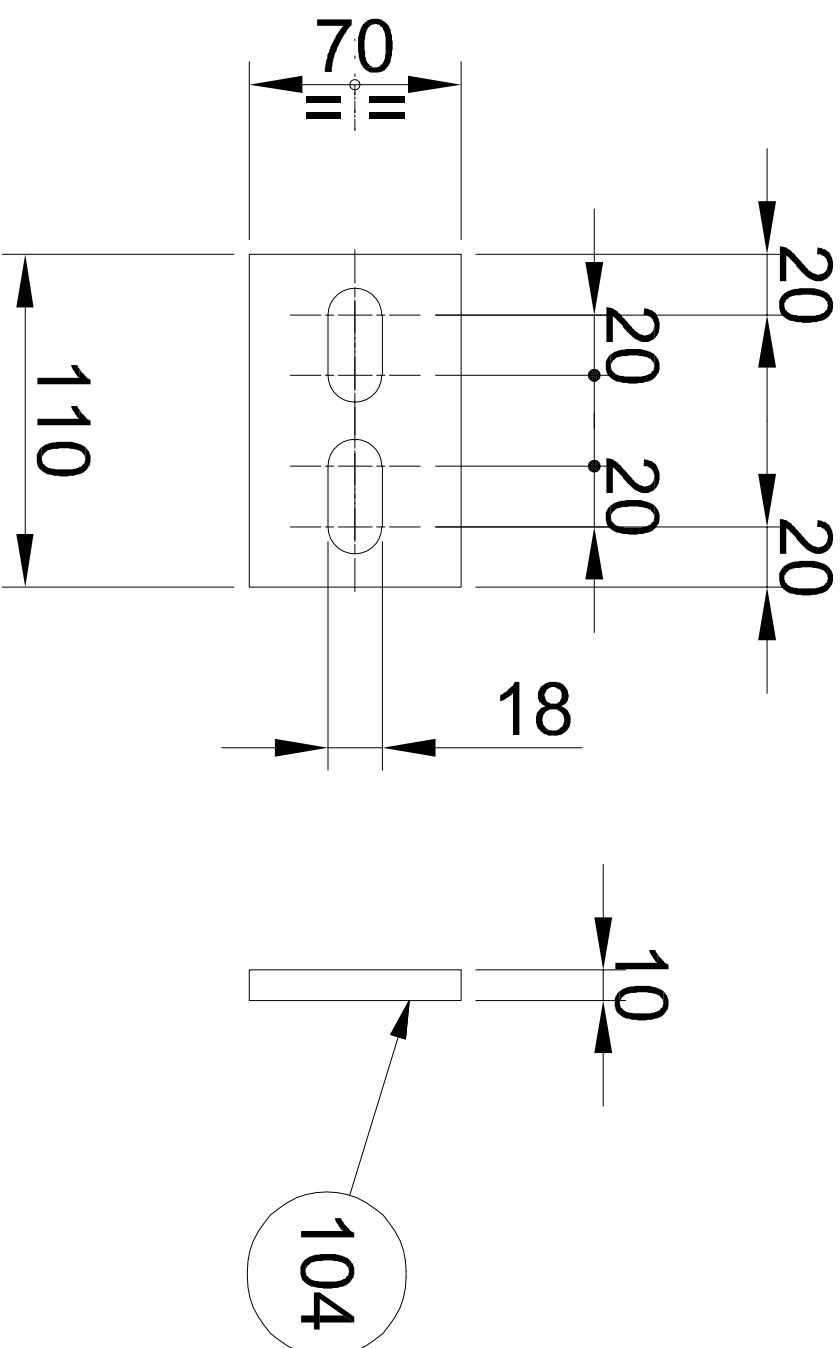

PAINTING STANDARDS

Paint the unworked surfaces as indicated:
- n°1 layer of Inorganic Zinc, thickness 75µm.
- n°1 or more layers of two-component epoxy paint, thickness 175µm.
The thickness of the final layer will therefore be no less than 250µm.

RAL

NORME GENERALI DI SALDATURA GENERAL RULES FOR WELDED JOINTS

PREPARAZIONE DEI LEMBI SECONDO "DIN 1912"
EDGE PREPARATION FOR WELDING ACCORDING TO
DOVE NON AL TRIMMENTI INDICATO - A = 0.7
DELLO SPESSORE MINIMO DA COLLEGARE
WHERE NOT SPECIFIED - A = 0.7
OF THE MINIMUM THICKNESS TO BE JOINT

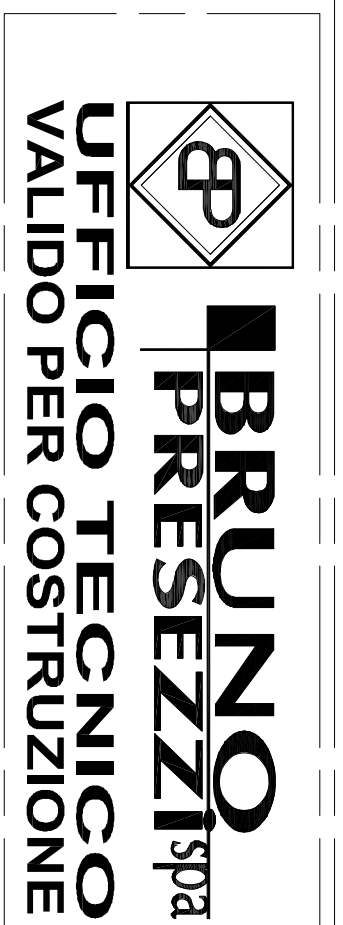

1	Plastra	Plate	106	S275JR EN 10025		0,7	
1	Plastra	Plate	105	S275JR EN 10025		0,7	
2	Plastra	Plate	104	S275JR EN 10025		0,6	
1	Plastra	Plate	103	S275JR EN 10025		1,1	
1	Profilato UPN 80 - L=970 UNI EN 10279	Profile UPN 80 - L=970	102	S275JR EN 10025		1,1	
1	Profilato UPN 80 L=1220 - UNI EN 10279	Profile UPN 80 - L=1220	101	S275JR EN 10025		1,3	

Q.tà	Descrizione	Description	Pos.	Materiale	Numero Parte	Massa	R.C.
------	-------------	-------------	------	-----------	--------------	-------	------

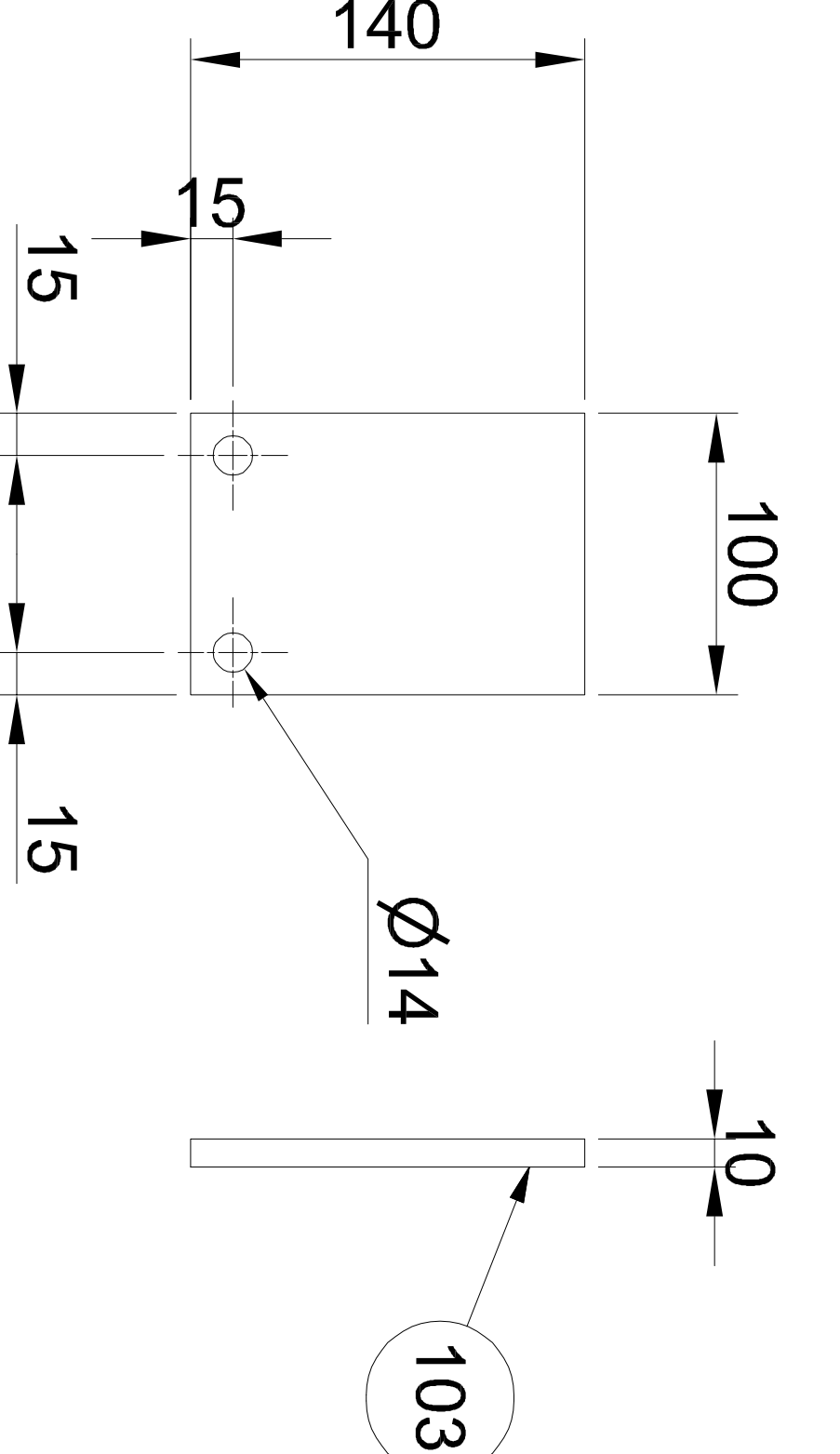
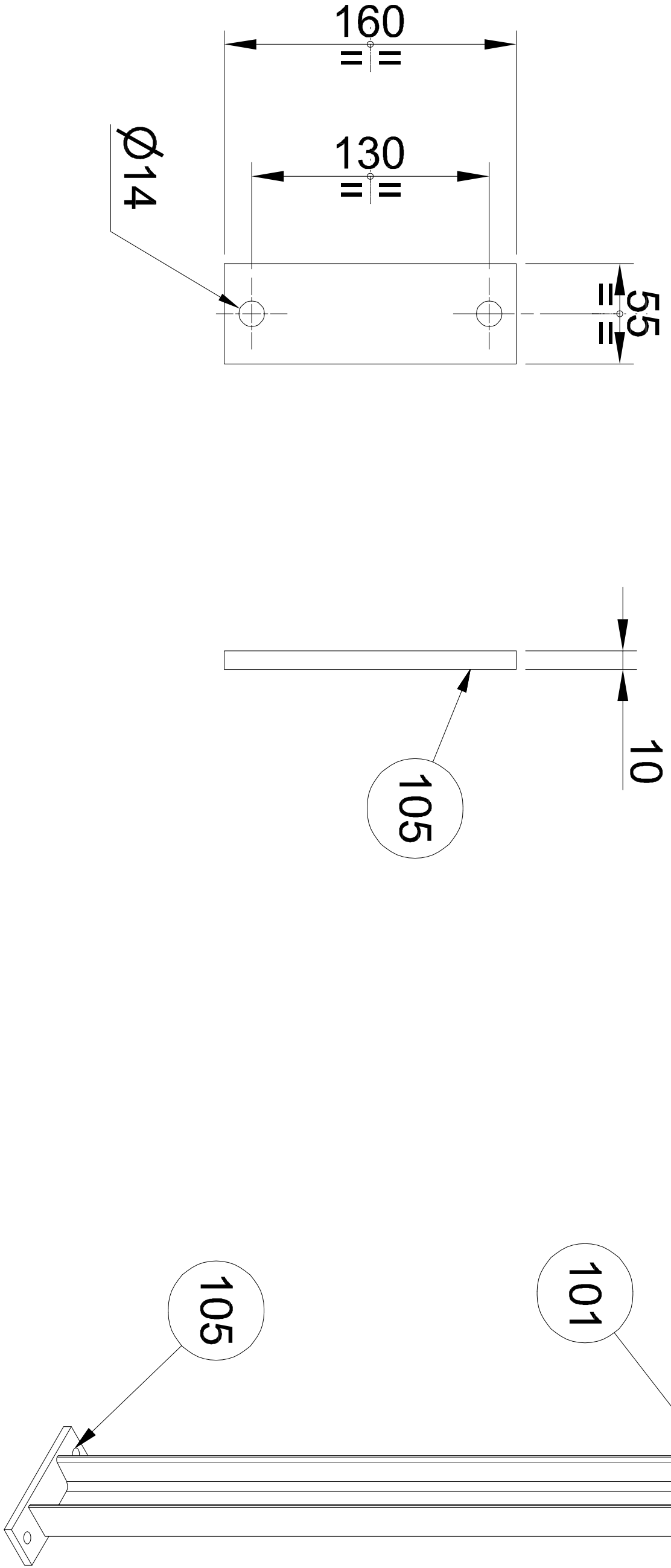

8 7 6 5 4 3 2 1